

Menus

Menu

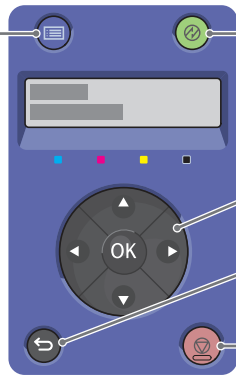

Power Saver On/Off

Arrow buttons scroll up, down, forward, and back through the menus. Press the left arrow to display the Walk-Up Features menu and list Secure Jobs and Saved Jobs.

OK button accepts the menu selection.

Back/Return button goes up one level in the menu.

Cancel button cancels printing jobs.

Information Pages

- Menu Map
- Configuration
- PCL Fonts List
- PCL Macros List
- PS Fonts List
- PDF Fonts List
- Job History
- Error History
- Print Meter
- Demo Page
- Stored Documents

Billing Meters

- Total Impression
- Color Impression
- Black Impression

Admin Settings

- PCL Settings ▶
- PDF Settings ▶
- PS Settings ▶
- Network Setup ▶
- USB Settings ▶
- System Settings ▶
- Service Tools ▶
- Secure Settings ▶

- Quantity
- 2-Sided Print**
- Print Mode
- PDF Password
- Collated
- Output Size
- Layout
- Output Color

- PS Error Report
- PS Job Timeout
- PaperSelect Mode
- Default Color

- Paper Tray
- Paper Size
- Orientation
- 2-Sided**
- Font
- Symbol Set
- Font Size
- Font Pitch
- Form Line
- Quantity
- Image Enhance
- Hex Dump
- Line Termination
- Default Color
- Ignore Form Feed

- Ethernet
- Wi-Fi Status*
- Wi-Fi Setup*
- WPS Setup*
- Reset Wi-Fi*
- TCP/IP
- Protocols
- Host Access List
- Reset Defaults
- Adobe Protocol

- USB Port
- Adobe Protocol

- Energy Saver
- Panel Timeout
- Fault Timeout
- Job Timeout
- Clock Settings
- Audio Tones
- mm / inch
- Default Size
- Auto Log Print
- 2-Sided Report**
- Print ID
- Print Text
- Banner Page
- RAM Disk*
- Size Mismatch
- Startup Page
- LetterH Dup Mode**
- Low Toner Msg
- S/W Download
- Power On Wizard

Tray Settings

- Bypass Tray
- Tray 1
- Tray 2*
- Tray Priority

Panel Language

- | | | |
|----------|------------|----------|
| English | Nederlands | Polski |
| Français | Português | Türkçe |
| Italiano | Svenska | Suomi |
| Deutsch | Русский | Norsk |
| Español | Magyar | Ελληνικά |
| Dansk | Česky | |



www.xerox.com/office/6600docs

* Option
** Phaser 6600DN